

11820 Central Parkway

11820 Central Parkway Jacksonville, FL 32224

| | |
|------------------------|------------|
| Use | Warehouse |
| Building Area | 67,200 SF |
| Land Area | 5.10 Acres |
| Parking Spaces | 77 |
| Truck Docks and Pads | 4 |
| Distance from SR 9A | .5 mi. |



Built in 1981 by Maidenform, this tilt-up concrete warehouse is located at Beach Boulevard at St. Johns Bluff, near the Jacksonville beaches. Other park users include Pilot Pen, Simple Signman, North Florida Sales Inc., the local Anheuser-Busch distributor, Venus Swimwear, Nordskog, B.E. Aerospace. Land for expansion.

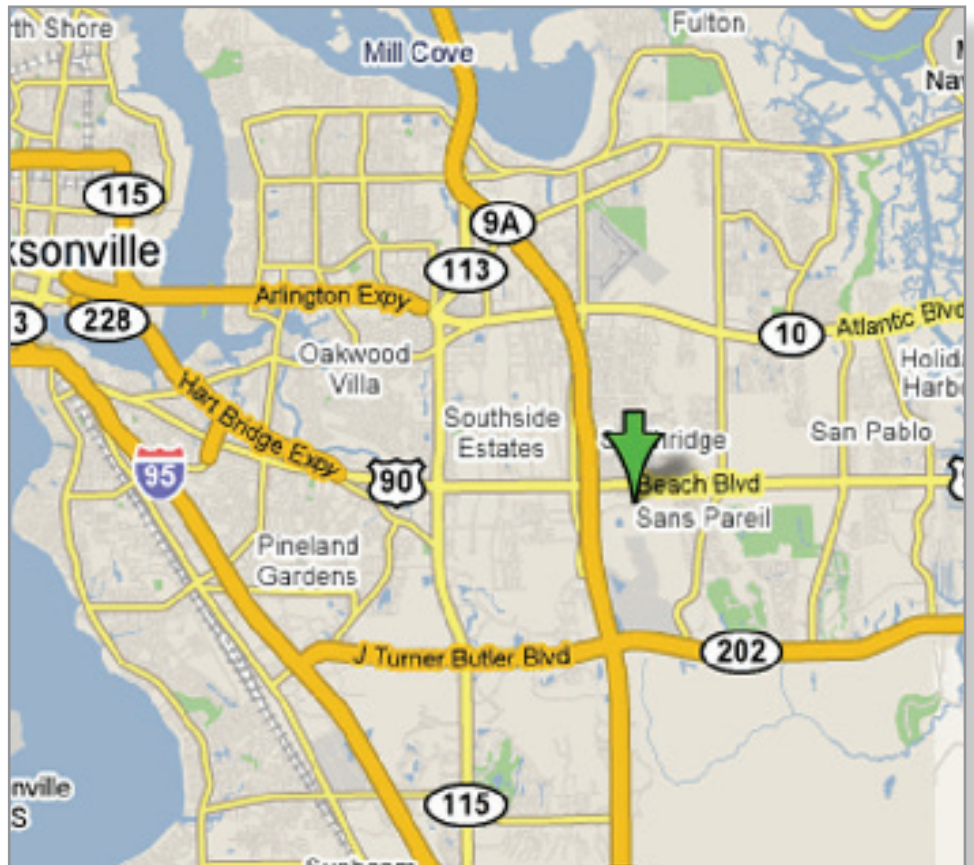

11820 Central Parkway



Property Info

| | |
|----------------------|--|
| Year Built | 1981 |
| Year Acquired | 1997 |
| Parking Spaces | 77 |
| Truck Docks and pads | 4 |
| Clear Height | 23 ft. |
| Bay Spacing | 40 x40 |
| Office Area | 7,700± SF |
| Sprinklers | Yes |
| Water pressure | 90 psi |
| Zoning | IBP-2 |
| Electric Service | 480V 3-phase |
| Phone/Data/T-1 | All available |
| HVAC overview | Office Areas: Electric heat pumps (27.5 ton total capacity) are used to provide heating and A/C to the office areas, warehouse office and warehouse toilet rooms. The warehouse area has electric heaters and through wall cross ventilation fans and vents. |

Floor Plan

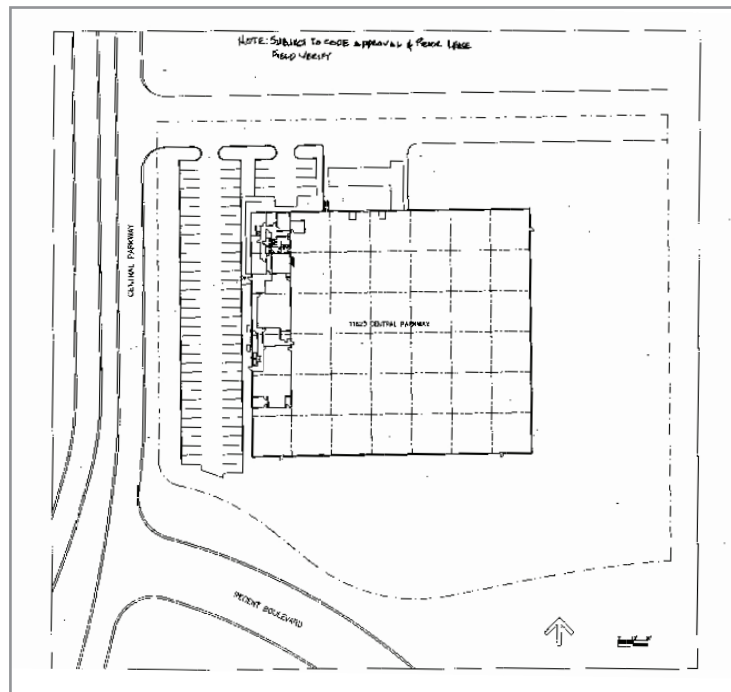

We believe this information to be accurate but no express or implied warranty or representation is made. This information is posted subject to errors and omissions, and does not constitute an offer to lease. This property may be subject to an exclusive listing agreement.